

VISOR® V20 Object Advanced, C-mount

Vision sensor for object detection, presence check, completeness check, position inspection and measurement tasks

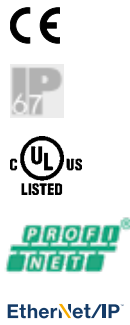

PRODUCT HIGHLIGHTS

- User-friendly configuration and viewer software with hierarchical user rights
- Object detection with 1.5 megapixel chip
- Real-world engineering units at a mouse click
- Precise position determination: X/Y-position and orientation
- Comprehensive logic and calculation functions for maximum flexibility
- Encoder input

| Optical data | | Functions | |
|--|---|--------------------------------|---|
| Resolution | 1440 x 1080 pixels | Number of jobs / detectors | Max. 255 / max. 255 |
| Imaging chip CMOS | 1/2.9", monochrome / color | Detectors | Position tracking; X/Y and orientation; Pattern matching, contour: teach-in and detection of patterns and contours; Calliper: distance between edges; BLOB, grey threshold, brightness: evaluation of brightness; Contrast: evaluation of contrast; Color value¹: output of color values; Color area¹: area inspection of colors, with selectable tolerance; Color list¹: finding the most similar colors; Result processing; Math: checking and calculating with results from detectors |
| Integrated lens, focal length [mm] | C-mount | | |
| Pixel size | 3.45 µm x 3.45 µm | | |
| Focus | Manual | | |
| Adjustment range | Dependent on lens | | |
| Integrated illumination | None | | |
| Minimum field of view, X x Y | Dependent on lens | | |
| Target laser | No | | |
| Electrical data | | Mechanical data | |
| Operating voltage, +U _B | 18 ... 30V DC ² | Dimensions | 70.4 x 45 x 45 mm (without plug) |
| Current consumption (without I/O) | ≤ 300 mA | Enclosure rating | IP 67 & IP 65 ³ |
| Protective circuits | Reverse-polarity protection, U _B / short-circuit protection of all outputs | Material, housing | Aluminium, die-cast, RoHS compliant |
| Power On Delay | Approx. 13 s after Power on | Material, front screen | Plastic |
| Outputs | PNP/NPN (switchable) | Ambient temperature: operation | 0 ... +50 °C ⁴ |
| Max. output current (per output) | 50 mA, 100 mA (pin 12) | Ambient temperature: storage | -20 ... +60 °C ⁴ |
| Switching threshold inputs incl. encoder | PNP/NPN High > U _B -1V / Low < 3V | Weight | Approx. 200 g |
| Input resistance | > 20 kΩ | Plug connections | Supply and I/O M12, 12-pin, Ethernet M12, 4-pin |
| Interfaces | Ethernet (LAN), EtherNet/IP, PROFINET, SensoWeb, Service Port | Vibration resistance | EN 60068-2-6 |
| Inputs/outputs | 2 inputs, 2 outputs, 6 selectable inputs/outputs | Shock resistance | EN 60068-2-27 |
| Encoder | ✓ | | |

¹ Color hardware ² Max. ripple < 5V_{ss} ³ Only with protective casing ⁴ 80 % air humidity, noncondensing

VISOR® vision sensor C-mount

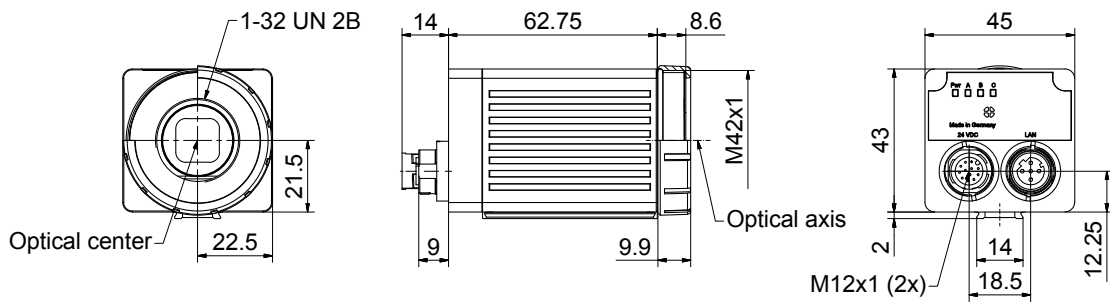

153-13555

3



| Part number | Article number |
|---------------|----------------|
| LPT Vxx-G37.5 | 651-01006 |
| LPT Vxx-25.0 | 651-01007 |

| | LOC-08-HD-30.5x0.5 | LOC-12-HD-27x0.5 | LOC-16-HD-27x0.5 | LOC-25-HD-27x0.5 | LOC-35-HD-27x0.5 | LOC-50-HD-27x0.5 | LOC-75-HD-34x0.5 |
|----------------|--------------------|------------------|------------------|------------------|------------------|------------------|------------------|
| Focal length | 8 mm | 12 mm | 16 mm | 25 mm | 35 mm | 50 mm | 75 mm |
| Article number | 526-51535 | 526-51536 | 526-51537 | 526-51538 | 526-51539 | 526-51540 | 526-51541 |

| Part number | Article number | Accessories |
|----------------|----------------|-----------------------|
| V20-OB-A3-C-2 | 632-91040 | Connection cables |
| V20C-OB-A3-C-2 | 632-91044 | Illumination |
| | | Lenses |
| | | Brackets |
| | | Interface accessories |

www.sensopart.com/en/accessories